

International Society for the Advancement of Clinical Magnetoencephalography

ISACM meeting 2013 JAPAN

Program & Abstracts

Date

August 27, Precongress

August 28-30, 2013

Conference Venue

Tokyo Dome Hotel Sapporo (**SAPPORO**)



CONTENTS

Welcome Message -----	1
Outline -----	2
Organization -----	3
Program at a Glance -----	4
Floor Plan -----	6
Congress Information -----	8
Instruction for Invited Authors and Chairs -----	9
Instruction for Authors of Poster Session -----	10
Program	
- Tuesday, August 27 -----	12
- Wednesday, August 28 -----	12
- Thursday, August 29 -----	15
- Friday, August 30 -----	18
Abstracts	
- Special Lecture (SL1 ~ SL4) -----	20
- Didactic Lecture Session (DL1 ~ DL8) -----	28
- Evidence Report (R-1 ~ R-3) -----	76
- Hands-on Workshop (HO-1 ~ HO-4) -----	82
- Satellite Symposium (SS-1 ~ SS-3) -----	90
- Poster Session (P1-01 ~ P1-20 / P2-01 ~ P2-19) -----	96
Sponsors -----	136

WELCOME MESSAGE

Dear Colleagues,

On behalf of the local organizing committee of the 4th International Society for the Advancement of Clinical Magnetoencephalography (ISACM 2013), it is our great pleasure to welcome all of you here in Sapporo. This meeting was co-organized by ISACM mainly with the assistance of its Executive Committee members. Although we have been faced with the difficulties of a business recession, generous subsidies from supporting organizations and companies have enabled us to manage this meeting. Based on the achievements of the previous meetings, Matsushima, Japan (2007), Athens, Greece (2009) and Las Vegas, USA (2011), we have moved forward by having a wider area of program arrangement. Four special lectures were aimed to expand our expertise in clinical MEG. Around 30 invited speakers covered 8 conventional MEG topics in a series of didactic lectures. Methodology-based evidence reports will be given by three specialists in Japan. We have received 39 abstracts for poster presentation for which each presenter has an opportunity to make a short oral appeal just before the standing session. Poster award will be offered to a selected author from these poster sessions. Our first trial to set up four hands-on sessions of different kinds of MEG analysis tools for beginners will run parallel.

As we aim to apply MEG analysis for clinical purposes, analysis procedures handling every single digital code should connect together to aid the advancement of disease treatment.

I hope this meeting will take a giant step beyond unraveling neuromagnetic signals.

Sapporo is characterized as being a new development in Japan, though one which has more than 140 years of history, accepting people from other areas. After the flow of history, people here are empathetic and open-minded, and trying to get ahead of the times.

I hope you will enjoy not only the scientific air of excitement but also some attractive social programs in the atmosphere of late-summer days in Sapporo and other areas of Hokkaido.



Takashi Nagamine, MD, PhD

President, International Society for the Advancement of Clinical MEG (ISACM)

Convener, 4th ISACM meeting 2013

OUTLINE

ISACM meeting 2013

International Society for the Advancement of
Clinical Magnetoencephalography meeting 2013

Main Theme

- Beyond unraveling neuromagnetic signals -

Dates

August 27 - 30, 2013

Venues

Tokyo Dome Hotel Sapporo
8, Odori-Nishi, Chuo-Ku, Sapporo, Hokkaido 060-0042 JAPAN
TEL +81-11-261-0111

President

Takashi Nagamine, M.D., Ph.D.
Department of Systems Neuroscience,
School of Medicine, Sapporo Medical University

Secretariat

Department of Systems Neuroscience,
School of Medicine, Sapporo Medical University
West 17 South 1 Chuo-ku, Sapporo, Hokkaido 060-8556 JAPAN
TEL: +81-11-611-2111(Ext. 2663) FAX: +81-11-644-1020
E-mail: contact@isacm2013.hkdo.jp

<http://isacm2013.hkdo.jp>

ORGANIZATION

ISACM meeting 2013 CONFERENCE ORGANIZERS

Local Organizing Committee:

Takashi Nagamine (Sapporo)
Shun Shimohama (Sapporo)
Nobuhiro Mikuni (Sapporo)
Shozo Tobimatsu (Fukuoka)
Nobukazu Nakasato (Miyagi)
Kyouzuke Kamada (Asahikawa)
Tatsuya Mima (Kyoto)
Shogo Yazawa (Sapporo)
Hideaki Shiraishi (Sapporo)
Jun Shinozaki (Sapporo)

Program Committee:

Ryohei Ishii (Osaka)
Isamu Ozaki (Aomori)
Ryusuke Kakigi (Aichi)
Shigeki Kameyama (Niigata)
Fumiya Takeuchi (Sapporo)
Naohiro Tsuyuguchi (Osaka)
Kazuhito Tsuruta (Miyazaki)
Akinori Nakamura (Aichi)
Nobuyuki Nishitani (Osaka)
Akira Hashizume (Hiroshima)
Masayuki Hirata (Osaka)
Hitoshi Maezawa (Sapporo)
Masato Yumoto (Tokyo)
Koichi Yokosawa (Sapporo)
Shiro Yorifuji (Osaka)
Susan Bowyer (Detroit)
Michael Funke (Utah)
Jeffrey Lewine (Kansas)
Yung-Yang Lin (Taipei)
Fernando Maestú (Madrid)
Jyrki Mäkelä (Helsinki)
Takashi Nagamine (Sapporo)
Ritva Paetau (Helsinki)
Stefan Rampp (Erlangen)
Timothy Roberts (Philadelphia)

Poster Award Committee: chair

Timothy Roberts (Philadelphia)

ISACM Inc. EXECUTIVE COMMITTEE

President

Takashi Nagamine (Sapporo)

Vice-President/President-Elect

Ritva Paetau (Helsinki)

Past-President

Timothy Roberts (Philadelphia)

Secretary

Jyrki Mäkelä (Helsinki)

Treasurer

Susan Bowyer (Detroit)

Executive Committee members:

Susan Bowyer (Detroit)
Michael Funke (Utah)
Jeffrey Lewine (Kansas)
Yung-Yang Lin (Taipei)
Fernando Maestú (Madrid)
Jyrki Mäkelä (Helsinki)
Takashi Nagamine (Sapporo)
Ritva Paetau (Helsinki)
Stefan Rampp (Erlangen)
Timothy Roberts (Philadelphia)

PROGRAM AT A GLANCE

August 27 (Tue.)	August 28 (Wed.)
	8:00
	8:30
	8:50-9:00 Opening
	9:00-10:30 DL1: Developmental disorders Chair : Hideaki Shiraishi DL1-1 Mitsuru Kikuchi DL1-2 Timothy Roberts DL1-3 Kazuyori Yagyu
	10:00
	10:30 intermission (30min)
	11:00-12:30 DL2: Language function Chair : Ritva Paetau DL2-1 Ryan D'Arcy DL2-2 Susan Bowyer DL2-3 Dawn Eliashiv
	11:30
	12:00
	12:30 Lunch time (60min) < Exco meeting >
	13:00
13:00-15:00 Satellite : Hokkaido MEG Society Introduction to MATLAB for MEG user (Japanese session)	13:30-14:15 Special Lecture 1 SL1 Daisuke Oyama Chair : Isamu Ozaki
	14:00
	14:30-15:00 Special Lecture 2 SL2 Walter Paulus Chair : Tatsuya Mima
	15:00 intermission (30min)
15:30-17:30 Satellite Symposium : Elekta Chair : Kyousuke Kamada SS-1 Richard Burgess SS-2 Fernando Maestú SS-3 Lauri Parkkonen	15:30-16:15 Poster Session 1 Oral (P1-01 ~ P1-20) Chair : Kyousuke Kamada
	15:30
	16:00-16:30 Poster Session 1 Standing (P1-01 ~ P1-20)
	16:30
	17:00-18:30 DL3: Epilepsy 1 Chair : Hiroshi Otsubo DL3-1 Ritva Paetau DL3-2 Hisako Fujiwara DL3-3 Steven Stufflebeam
	17:30
17:30~ Welcome Reception (Entrance free)	18:00
	18:30 < Business meeting > * Take Commemorative Picture
	19:00

August 29 (Thu.)	
8:00-9:00	Evidence Report Chair : Stefan Rampp R-1 Isamu Ozaki R-2 Masato Yumoto R-3 Shozo Tobimatsu
9:00-10:30	DL4: Dementia and mild cognitive impairment Chair : Susan Bowyer DL4-1 Yung-Yang Lin DL4-2 Akinori Nakamura DL4-3 Fernando Maestú
intermission (30min)	
11:00-12:30	DL5: Parkinson Disease Chair : Takashi Nagamine DL5-1 Atsushi Nambu DL5-2 Ashwini Oswal DL5-3 Jyrki Mäkelä
Lunch time (60min)	
13:30-14:15	Special Lecture 3 SL3 Hidenao Fukuyama Chair : Shun Shimohama
14:15-15:00	Special Lecture 4 SL4 Seppo Ahlfors Chair : Hideaki Shiraishi
intermission (15min)	
15:15-16:00	Poster Session 2 Oral (P2-01 ~ P2-19) Chair : Masato Yumoto
16:00-16:45	Poster Session 2 Standing (P2-01 ~ P2-19)
16:45-18:15	DL6: Neurosurgery and MEG Chair : Nobuhiro Mikuni DL6-1 Chun Kee Chung DL6-2 Masaki Iwasaki DL6-3 Kyousuke Kamada
Poster Award announced	
< Banquet & Sapporo night view tour > 18:30 departing at Tokyo Dome Hotel Sapporo	

August 30 (Fri.)	
8:00	
8:30	
9:00	9:00-10:30 Hands-on Workshop (at the same time)
9:30	[HO-1] [HO-2] [HO-3] [HO-4] Akira Naruhito Naoaki Lauri Hashizume Hironaga Tanaka Parkkonen
10:00	
10:30	intermission (30min)
11:00	11:00-12:30 DL7: Network and Oscillation Chair : Jyrki Mäkelä DL7-1 William Gaetz DL7-2 Toshiaki Onitsuka DL7-3 Stefan Rampp
11:30	
12:00	
12:30	
13:00	Lunch time (60min)
13:30	
14:00	13:30-15:00 DL8: Epilepsy 2 Chair : Chun Kee Chung DL8-1 Hiroshi Otsubo DL8-2 Pauly Ossenblok DL8-3 Michael Scherg
14:30	
15:00	Closing
15:30	
16:00	
16:30	
17:00	
17:30	
18:00	
18:30	
19:00	

FLOOR PLAN

B2F

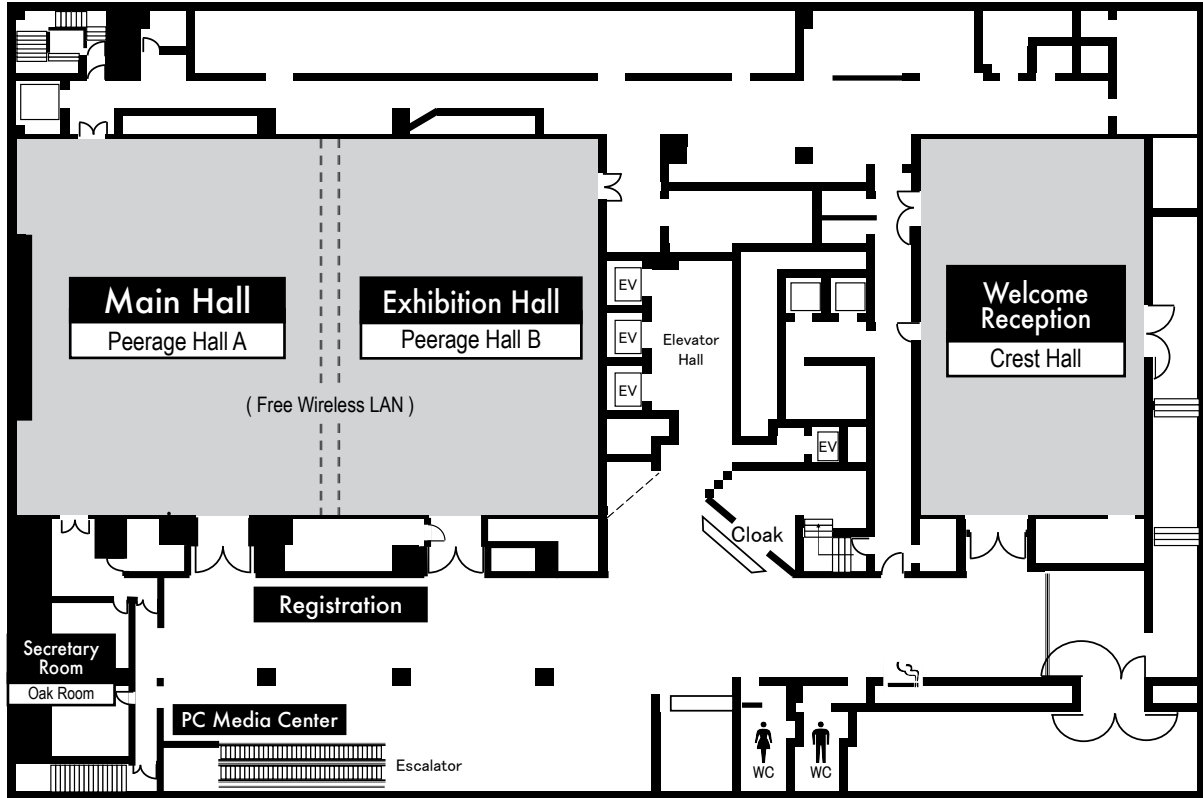

4F

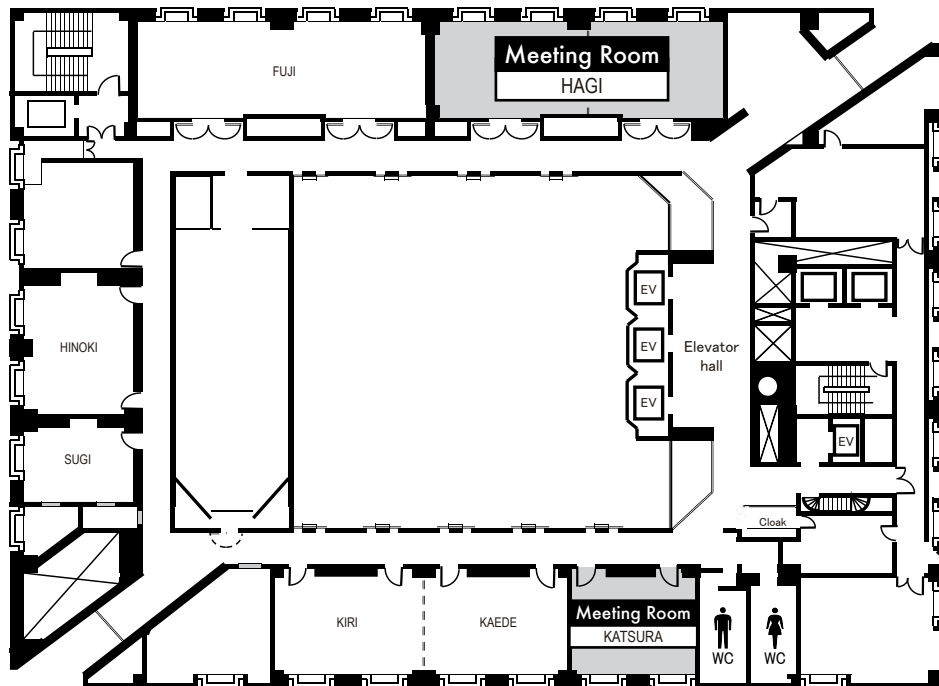

Exhibition Hall

Peerage Hall B

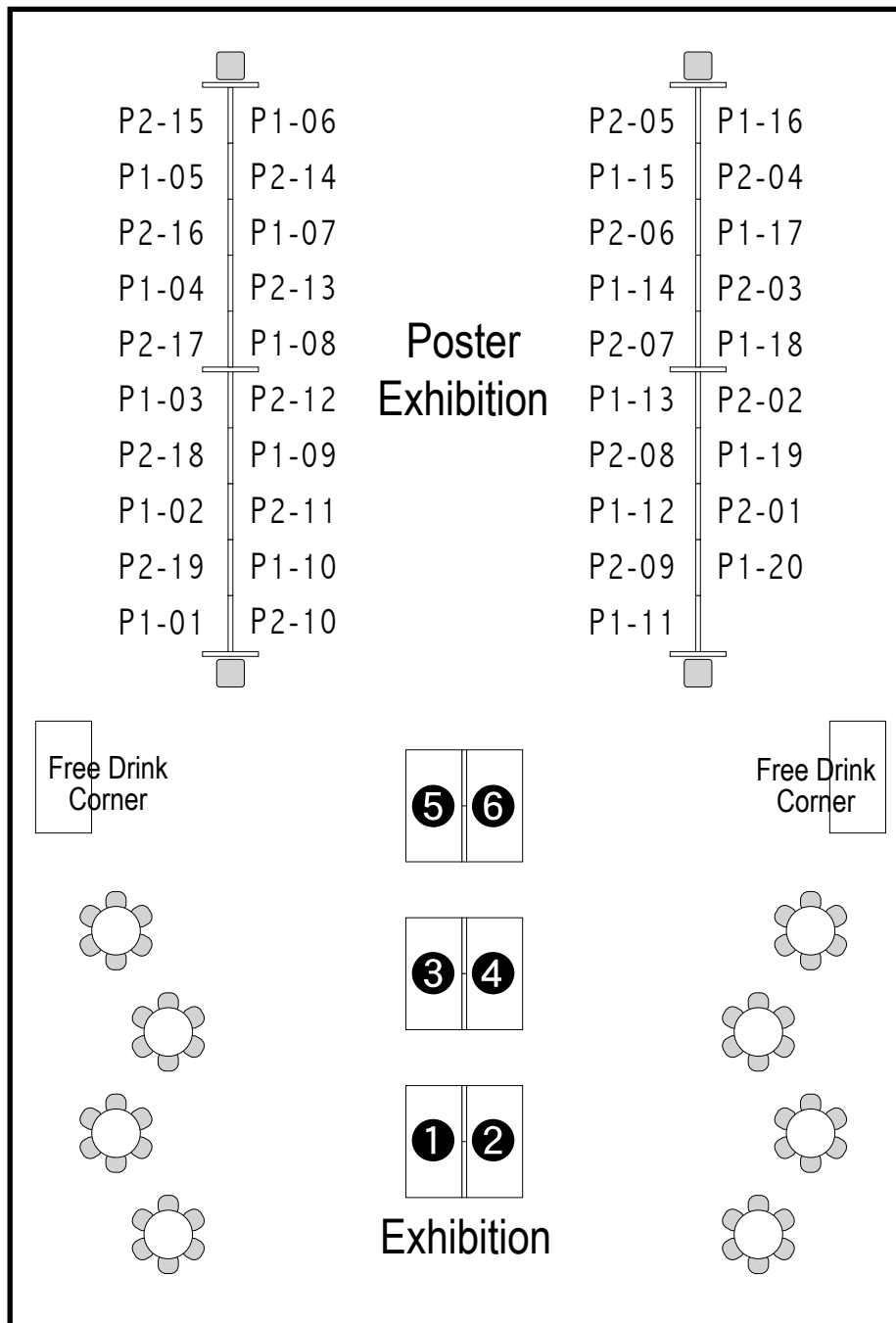

- ① Elekta
- ② BESA GmbH
- ③ Quantum Design Japan, Inc.
- ④ NAMOTO Trading Co.,Ltd.
- ⑤ Monte System Corporation
- ⑥ Compumedics

CONGRESS INFORMATION

1. Registration

- Registration Desk : B2F Floor
- Open Hours :
August 27, Tue, 12:30-18:00
August 28, Wed, 08:00-17:00
August 29, Thu, 07:00-18:00
August 30, Fri, 08:00-13:00
- Regular registration fee includes :
 - Admission to all scientific sessions and the Hands-on Workshop.
 - Satellite Session and Welcome Reception on August 27th.

2. Name Badge

Delegates are required to wear the name badges throughout the entire conference.

3. Social events

- **Welcome Reception**
Date : August 27, Tue, 17:30~
Venue : Tokyo Dome Hotel Sapporo B2F "Crest Hall"
*Entrance free
- **Banquet & Sapporo night view tour**
Date : August 29, Thu, 18:30~
Venue : Mt. Okura
Banquet Fees : JPY6,000
*Incl. transportation (between Tokyo Dome Hotel Sapporo and the restaurant), dinner (Hokkaido-Style Genghis-khan, mongolian barbeque) with free drinks (90 minutes) and ski lift ticket (return).
*Sit-down style
[Time Schedule]
18:30 departing at Tokyo Dome Hotel Sapporo
19:00 arriving at Mt. Okura ~ Night viewing by riding on the double lift ~
19:30- dinner at Mt. Okura "Ram Dining" restaurant
21:30 departing at Mt. Okura
22:00 arriving at Tokyo Dome Hotel Sapporo

4. Secretariat

During the Meeting
Please visit the Registration Desk (B2F). Secretary Room "Oak Room" (B2F) is for private use only.

5. Audio or Video Recording

NO AUDIO OR VIDEO RECORDING, please, during oral sessions, unless permitted officially by the conference.

6. Message Board

You may post or check messages on the conference "Message Board" in front of "Registration Desk".

INSTRUCTION for Invited Authors and Chairs

To Speakers

- All presentations should be prepared to work on Microsoft PowerPoint.
- Your PC-based presentation with your own laptop computer is strongly recommended.
- 35mm Slide, overhead, or VCR projectors will not be accepted.
- Ensure "mini D-sub 15 pins" is equipped in your PC, or bring an appropriate converter with you.
- Please, verify that the size of your PowerPoint files is adapted to an on-screen-show. Available display mode is XGA (1024 x 768 dots).
- For audio files output, we prepare mini-pin. If you need special equipment for your presentation, please bring an appropriate converter with you.
- Please also bring an AIC adaptor (100 V, 50 Hz).

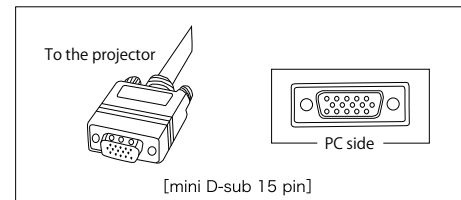

- Our PC Media Center is located in front of Main hall (B2F Peerage Hall A).
 - We recommend your visit at least 30 minutes before your session starts.
 - At PC Media Center, we will check your PC setting to cancel sleep/power-saving function or screen-saver of your PC monitor.
 - We recommend that you also check them by yourself beforehand.
-
- Please hand your PC over the operator desk located just beside the podium before your session starts.
 - On the podium, a display monitor, a keyboard and a remote mouse will be provided for your operation.
-
- If you bring your data in a CD-ROM or a USB flash memory stick, we accept only PowerPoint files in Windows (PowerPoint 2003/2007/2010). We do not recommend the use of earlier versions anymore.
 - Please do not use Macintosh software to create your presentation.
 - For proper presentation, please use following fonts: Times New Roman, Arial, Arial Black, Arial Narrow, Century, Century Gothic, Courier New or Georgia.
 - We guarantee that your presentation files are destroyed at the end of day or at the end of the Congress.
 - If your presentation uses digital video or audio files, please bring your own laptop computer.
-
- We strongly recommend that you bring a spare copy of your presentation on CD-ROM or USB memory stick, even if your presentation exists in your laptop PC.

To Chairs

- Please be seated at the Next Chairs Seat in the front row at least 10 minutes prior to your session.
- Chairs are responsible for the smooth progress of the session and following the time schedule.

INSTRUCTION for Authors of Poster Session

Time Table

	Posting	Oral	Standing	Removal
August 27	13:00 - 18:00	-	-	-
August 28	8:00 - 11:00	15:30 - 16:15 (P1-01~P1-20)	16:15 - 17:00 (P1-01~P1-20)	-
August 29	-	15:15 - 16:00 (P2-01~P2-19)	16:00 - 16:45 (P2-01~P2-19)	-
August 30	-			13:00 - 15:00

Have time to oral presentation of poster summary.

After the oral presentation, a free discussion session will be held in the poster exhibition area.

Oral (Presentation of poster summary)

- Oral Presentation time / 2 min (No Discussion time)
- at Main Hall (Tokyo Dome Hotel Sapporo B2F Peerage Hall A)

Standing (Free Discussion)

- Free Discussion time / 45 min
- at Exhibition Hall (Tokyo Dome Hotel Sapporo B2F Peerage Hall B)

[Panel Size]

- Each panel size is W90cm × H210cm.
- Display Space is W90cm × H150cm.
- Do not posted on the gray zone(W90cm × H40cm)
- Title, Authors and Affiliations are W70cm × H20cm.
- A Poster Number (20cm×20cm) will be provided by the Secretariat.
- Pushpins for set-up kit will be prepared by the Secretariat.

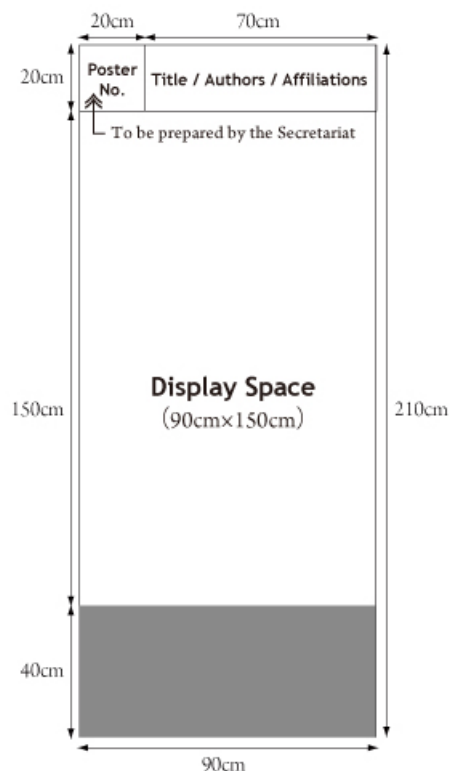

About the Poster Award

- Through Oral Presentation and free discussion session, Poster Award will be selected.
- We'll announce Excellence Poster Award after a session of DL6"Neurosurgery and MEG" on the 29th.

PROGRAM

Tuesday, August 27

13:00-15:00 **Satellite: Hokkaido MEG Society / Introduction to MATLAB for MEG user (Japanese session)**

15:00-15:30 **intermission**

15:30-17:30 **Satellite Symposium : Elekta**

Chair : Kyousuke Kamada (Department of Neurosurgery, School of Medicine, Asahikawa Medical University, Asahikawa, Japan)

SS-1 Clinical utility of magnetoencephalography in surgical management of epilepsy
Richard Burgess (USA)

SS-2 Potential clinical utility of magnetoencephalography in traumatic brain injury and Alzheimer's disease
Fernando Maestu (Spain)

SS-3 Machine learning and brain-computer interfacing with MEG: Clinical aspects
Lauri Parkkonen (Finland)

17:30- **Welcome Reception**

Wednesday, August 28

08:50-09:00 **Opening**

09:00-10:30 **Didactic Lecture Session 1 : Developmental disorders**

Chair : Hideaki Shiraishi (Department of Pediatrics, Hokkaido University Hospital, Sapporo, Japan)

DL1-1 Brain connectivity in young children with autism: child custom-sized MEG studies
Mitsuru Kikuchi (Japan)

DL1-2 Electrophysiological Signatures of Language Impairment in Autism Spectrum Disorders
Timothy Roberts (USA)

DL1-3 Cross correlation in neuropathology between schizophrenia and autism spectrum disorder using self-induced somatosensory evoked fields
Kazuyori Yagyu (Japan)

10:30-11:00 **intermission**

11:00-12:30 **Didactic Lecture Session 2 : Language function**

Chair : Ritva Paetau (Departments of Clinical Neurophysiology and Pediatric Neurology, Helsinki University Central Hospital, Helsinki, Finland)

DL2-1 Combined spatial MEG and fMRI laterality mapping for language: Merging technologies for optimization in epilepsy
Ryan D'Arcy (Canada)

DL2-2 Choral Speech effects on Stuttering
Susan Bowyer (USA)

DL2-3 Magnetic Source Imaging (MSI) and Atypical Language Representation in Epilepsy
Dawn Eliashiv (USA)

12:30-13:30 Lunch time (Exco meeting)

13:30-14:15 Special Lecture 1

Chair : Isamu Ozaki (Department of Physical Therapy, Faculty of Health Sciences, Aomori University of Health and Welfare, Aomori, Japan)

SL1 Calibration of Dry Phantom for MEG System Evaluation
Daisuke Oyama (Japan)

14:15-15:00 Special Lecture 2

Chair : Tatsuya Mima (Human Brain Research Center, Kyoto University Graduate School of Medicine, Kyoto, Japan)

SL2 Targeted modulation of cortical plasticity by transcranial electrical stimulation
Walter Paulus (Germany)

15:00-15:30 intermission

15:30-16:15 Poster Session 1 Oral

Chair : Kyousuke Kamada (Department of Neurosurgery, School of Medicine, Asahikawa Medical University, Asahikawa, Japan)

P1-01 Relationship Between Frequency Characteristics of Neuromagnetic Auditory Steady State Response and Hearing Ability
Asuka Otsuka (Japan)

P1-02 Amplitude Modulation of Transient MEG Responses Caused by Unexpected Chord Progressions
Tomoka Kadoya (Japan)

P1-03 Magnetoencephalographic Study on Statistical Learning and Relative Learning of Auditory Sequences
Tatsuya Daikoku (Japan)

P1-04 Differential Responses to Aversion Sound in Autistic Spectrum Disorder with Auditory Hypersensitivity: A MEG Study
Kuriko Kagitani-Shimono (Japan)

P1-05 Neuromagnetic Signatures of Aberrant Intrinsic Brain Activity in Autism Spectrum Disorder
Jing Xiang (USA)

P1-06 MEG Steady-State Gamma Responses in Children with and without Autism Spectrum Disorders: A Preliminary Study
Hidetoshi Takahashi (Japan)

P1-07 Left-lateralized auditory M100 in adult with autism spectrum disorders
Hayato Watanabe (Japan)

P1-08 Measurements of auditory evoked magnetic fields by bone-conducted ultrasound in the profoundly hearing-impaired
Seiji Nakagawa (Japan)

P1-09 Phonological-Semantic Relations in Dyslexia: A Developmental Perspective
Maria Mody (USA)

- P1-10 Altered auditory steady-state magnetic fields in bipolar disorders: A source localization study
Yuko Oda (Japan)
- P1-11 Superior temporal gyrus low-frequency and 40 Hz steady-state activity in schizophrenia: associations with gray matter and age
Christopher Edgar (USA)
- P1-12 Utility of Time-Frequency Analysis in Magnetoencephalography Under Huge Magnetic Noise due to Titanium Cranial Plate
Akitake Kanno (Japan)
- P1-13 Frontal and Superior Temporal Auditory Processing Abnormalities in Schizophrenia
Yu-Han Chen (USA)
- P1-14 Reduced Right Temporo-Parietal Hypoactivation by Emotion in Depression Depends on Family History of Depression
Stephan Moratti (Spain)
- P1-15 Clinical Application of Magnetoencephalography to Non-invasive Diagnosis of Cognitive Impairments
Nobuyuki Nishitani (Japan)
- P1-16 MEG Resting State Brain Connectivity in MCI Patients, Influence of ApoE Genotype on Network Disruption
Cuesta Pablo (Spain)
- P1-17 Clinical Value of Video in An MEG Examination
Andrey Zhdanov (Finland)
- P1-18 Analysis of ictal magnetoencephalography using gradient magnetic-field topography (GMFT)
Hiroshi Shirozu (Japan)
- P1-19 Coupling MNE and hns_meg Can Provide Speedy and Detailed MEG Epilepsy Analysis
Akira Hashizume (Japan)
- P1-20 An analysis of epileptic negative myoclonus by Magnetoencephalography
Masaki Yoshimura (Japan)

16:15-17:00 Poster Session 1 Standing (Exhibition Hall / P1-01~P1-20)

17:00-18:30 Didactic Lecture Session 3 : Epilepsy 1

Chair : Hiroshi Otsubo (Clinical neurophysiology, Division of Neurology, The Hospital for Sick Children, University of Toronto, Ontario, Canada)

- DL3-1 Magnetoencephalography (MEG) in Epilepsies with Generalized Seizures
Ritva Paetau (Finland)
- DL3-2 MEG in focal epilepsy for pediatrics
Hisako Fujiwara (USA)
- DL3-3 Integrating MEG with Advanced Multimodal Neuroimaging in Presurgical Epilepsy Patients
Steven Stufflebeam (USA)

18:30-

Business meeting

* Take Commemorative Picture

Thursday, August 29

08:00-09:00 Evidence Report

Chair : Stefan Ramm (University Hospital Erlangen, Department of Neurology, Epilepsy Center, Erlangen, Germany)

- R-1 Bibliographic survey on the stimulus methods and conditions for recording somatosensory evoked magnetic fields
Isamu Ozaki (Japan)
- R-2 Clinical Applications of Auditory Evoked Magnetic Fields: A Methodological Review
Masato Yumoto (Japan)
- R-3 A critical review on visual evoked magnetic fields: Importance of stimulus parameters
Shozo Tobimatsu (Japan)

09:00-10:30 Didactic Lecture Session 4 : Dementia and mild cognitive impairment

Chair : Susan Bowyer (Department of Neurology, Henry Ford Hospital, Detroit, Michigan, USA)

- DL4-1 Cortical repetition suppression and deviance detection: From normal aging to dementia
Yung-Yang Lin (Taiwan)
- DL4-2 Possible Functional Biomarkers for Alzheimer's Disease - Evaluations by Multimodal Neuroimaging
Akinori Nakamura (Japan)
- DL4-3 Brain network organization in the early stages of Alzheimer's Disease
Fernando Maestú (Spain)

10:30-11:00 intermission

11:00-12:30 Didactic Lecture Session 5 : Parkinson Disease

Chair : Takashi Nagamine (Department of Systems Neuroscience, Sapporo Medical University, Sapporo, Japan)

- DL5-1 Cortico-basal ganglia loop and pathophysiology of movement disorders
Atsushi Nambu (Japan)
- DL5-2 Cortico-basal ganglia connectivity and the pathophysiology of Parkinson's disease: insights from simultaneous MEG and deep brain recordings
Ashwini Oswal (UK)
- DL5-3 MEG in Parkinson's Disease: Modification of Cortical Signals by Deep Brain Stimulation
Jyrki Mäkelä (Finland)

12:30-13:30 Lunch time

13:30-14:15 Special Lecture 3

Chair : Shun Shimohama (Department of Neurology, Sapporo Medical University, Sapporo, Japan)

- SL3 Default Mode Network, reappraisal
Hidenao Fukuyama (Japan)

14:15-15:00 Special Lecture 4

Chair : Hideaki Shiraishi (Department of Pediatrics, Hokkaido University Hospital, Sapporo, Japan)

- SL4 Current and future computational innovation for clinical MEG research
Seppo P. Ahlfors (USA)

15:00-15:15 intermission

15:15-16:00 Poster Session 2 Oral

Chair : Masato yumoto (Department of Clinical Laboratory and Physiology, Graduate School of Medicine, The University of Tokyo, Tokyo, Japan)

- P2-01 Localization of High-Frequency Neuromagnetic Oscillations using a Wavelet-based Beamformer
Jing Xiang (USA)
- P2-02 Altered Functional Connectivity within Default Mode Network in Temporal Lobe Epilepsy:
A resting-state MEG study
Fu-Jung Hsiao (Taiwan)
- P2-03 Integrated MEG and fMRI Language Laterality Maps For Epilepsy
Sean McWhinney (Canada)
- P2-04 Characterizing functional connectivity of interictal MEG activity in epileptic patients using graph
theoretical analysis
Guiomar Niso (Spain)
- P2-05 Virtual MEG Helmet
Mordekhay Medvedovsky (Israel)
- P2-06 Central Excitability Changes in Chronic Tension-Type Headache:
A MEG Study of Sensory Gating
Wei-Ta Chen (Taiwan)
- P2-07 Recovery of impaired somatosensory evoked fields by tongue stimulation after oral surgery
Hitoshi Maezawa (Japan)
- P2-08 Analysis of Somatosensory Evoked Field by Using Temporal Spread Image
Sumiya Shibata (Japan)
- P2-09 Combined use of MEG and TMS to improve the noninvasive evaluation of language dominance
Masayuki Hirata (Japan)
- P2-10 HERMES: towards an integrated toolbox to characterize functional and effective brain connectivity
Guiomar Niso (Spain)
- P2-11 Fusion analysis of MEG and PET (or SPECT) using automated ROI constitution for assessing
cerebral ischemia
Junya Abe (Japan)
- P2-12 The clinical application of magnetoencephalography for stroke
Naohiro Tsuyuguchi (Japan)
- P2-13 Load Effect on Slow Magnetic Fields During Motor Execution: An MEG Study
Takanobu Toyoshima (Japan)

- P2-14 Movement-Related Cortical Oscillations and Parkinson's Disease
William Gaetz (USA)
- P2-15 Plastic Change of Human Corticomuscular Coherence After Anodal Transcranial DC Stimulation
Yusuke Mikami (Japan)
- P2-16 Corticokinematic Coherence—A Novel Means to Study Proprioceptive Afference to The Cortex
Harri Piitulainen (Finland)
- P2-17 Change of The Contra-Lateral Sensory Motor Cortex Caused by A Cerebellar Hemorrhage
Hirokazu Kawano (Japan)
- P2-18 Observation of The Sensory Motor Cortex After Cervical Central Spinal Cord Injury
Hirokazu Kawano (Japan)
- P2-19 Brain Activities During Motor Imagery: An MEG Study
Hidekazu Saito (Japan)

16:00-16:45 Poster Session 2 Standing (Exhibition Hall / P2-01~P2-19)

16:45-18:15 Didactic Lecture Session 6 : Neurosurgery and MEG

Chair : Nobuhiro Mikuni (Department of Neurosurgery, Sapporo Medical University, Sapporo, Japan)

- DL6-1 Clinical Application of Motor and Somatosensory MEG
Chun Kee Chung (Korea)
- DL6-2 Magnetoencephalography in epilepsy surgery: advantages and limitations
Masaki Iwasaki (Japan)
- DL6-3 Spatial and Temporal Dynamics of Visual Cognitive Processing on ECoG, fMRI and MEG
Kyouusuke Kamada (Japan)

18:15- Poster Award announced

18:30- Banquet & Sapporo night view tour
(18:30 departing at Tokyo Dome Hotel Sapporo)

Friday, August 30

09:00-10:30 **Hands-on Workshop (Four Workshop start at the same time)**

- HO-1 Concise epilepsy analysis software, hns_meg, for Elekta-Neuromag users
Akira Hashizume (Japan)
- HO-2 The SPM introductory course using SEF data: from installation to 3D reconstruction
Naruhito Hironaga (Japan)
- HO-3 Analyzing epileptic spikes by using MNE software
Naoaki Tanaka (USA)
- HO-4 Signal analysis by using Graph (Elekta)
Lauri Parkkonen (Finland)

10:30-11:00 **intermission**

11:00-12:30 **Didactic Lecture Session 7 : Network and Oscillation**

Chair : Jyrki Mäkelä (Biomag Laboratory, HUS Medical Imaging Center, Helsinki University Central Hospital, Helsinki, Finland)

- DL7-1 Functional significance and clinical relevance of movement-related cortical oscillations
William Gaetz (USA)
- DL7-2 Neural dynamics in patients with schizophrenia and bipolar disorder: differences and similarities
Toshiaki Onitsuka (Japan)
- DL7-3 MEG correlates of epileptic high gamma oscillations in invasive EEG
Stefan Rampp (Germany)

12:30-13:30 **Lunch time**

13:30-15:00 **Didactic Lecture Session 8 : Epilepsy 2**

Chair : Chun Kee Chung (MEG Center, Department of Neurosurgery, Seoul National University College of Medicine, Seoul, Korea)

- DL8-1 Diagnostic advance of MEG in epilepsy
Hiroshi Otsubo (Canada)
- DL8-2 EEG correlated functional MRI vs MEG in epilepsy research
Pauly Ossenblok (The Netherlands)
- DL8-3 Optimizing non-invasive interictal spike detection and localization in MEG
Michael Scherg (Germany)

15:00- **Closing**

Sponsors

Elekta

BESA GmbH

Exhibitor

Elekta

BESA GmbH

Quantum Design Japan, Inc.

NAMOTO Trading Co.,Ltd.

Monte System Corporation

Compumedics

Subsidies

The Federation of Pharmaceutical
Manufacturers' Associations of JAPAN

Sapporo Medical University

The ITO Foundation for the Promotion of
Medical Science

Hokkaido Medical Association